

Springwell Solar Farm

Streets, Rights of Way and Access Plans

APFP Regulation 5(2)(k)

Planning Act 2008

Infrastructure Planning
(Applications: Prescribed Forms
and Procedure) Regulations 2009

EN010149/APP/2.4.3

Revision 3

Deadline 1

June 2025

Springwell Energyfarm Ltd



Streets, Rights of Way and Access Plan – Drawing Revision Schedule

Drawing Title	Sheet Number	Revision	Reason for Revision
Streets, Rights of Way and Access Plans	Key Plan	03	Extension to a proposed permissive path and Public Right of Way
Streets, Rights of Way and Access Plans	Sheet 1 of 15	02	No further revision
Streets, Rights of Way and Access Plans	Sheet 2 of 15	02	
Streets, Rights of Way and Access Plans	Sheet 3 of 15	02	
Streets, Rights of Way and Access Plans	Sheet 4 of 15	02	
Streets, Rights of Way and Access Plans	Sheet 5 of 15	02	
Streets, Rights of Way and Access Plans	Sheet 6 of 15	02	
Streets, Rights of Way and Access Plans	Sheet 7 of 15	02	
Streets, Rights of Way and Access Plans	Sheet 8 of 15	02	
Streets, Rights of Way and Access Plans	Sheet 9 of 15	02	
Streets, Rights of Way and Access Plans	Sheet 10 of 15	03	Extension to a proposed permissive path and Public Right of Way
Streets, Rights of Way and Access Plans	Sheet 11 of 15	02	No further revision
Streets, Rights of Way and Access Plans	Sheet 12 of 15	02	
Streets, Rights of Way and Access Plans	Sheet 13 of 15	02	
Streets, Rights of Way and Access Plans	Sheet 14 of 15	02	
Streets, Rights of Way and Access Plans	Sheet 15 of 15	02	

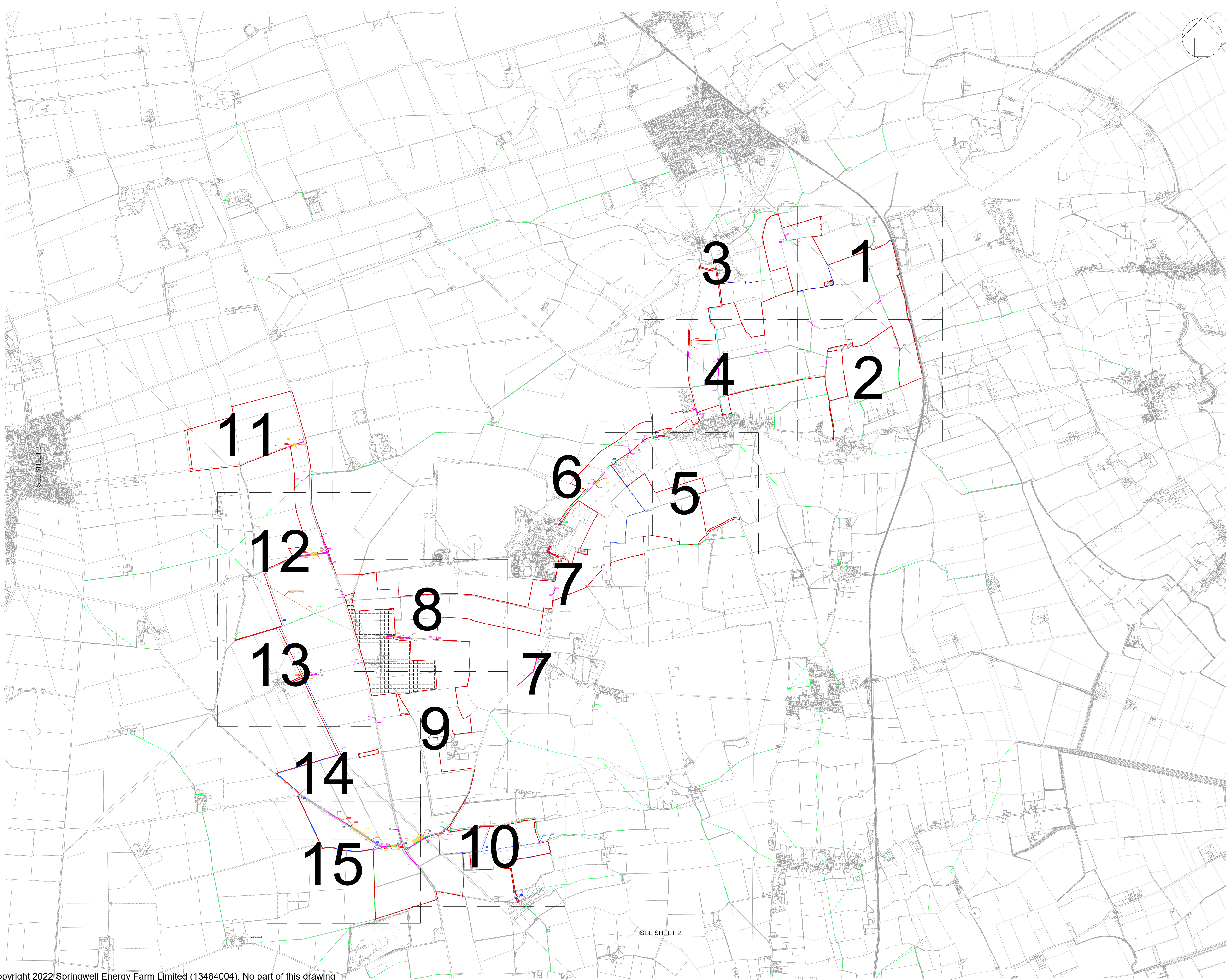

- KEY:
- [Red outline] Order Limits
 - [Red dashed outline] Areas outside of order limits
 - [Green line] Existing Public Rights of Way (PROW)
 - [Blue line] Existing Permissive Path (EP)
 - [Blue dashed line] Proposed Permissive Path (PP)
 - [Cyan line] Proposed Enhanced Public Right of Way (PE)
 - [Green dashed line] Proposed Public Right of Way (FP)
 - [AS-A1] Formation of a new access/passing bay (Location reference)
 - [AC-A2] Extents of a new access/passing bay (Location reference)
 - [PE-A1] Proposed Enhanced Public Right of Way (Location reference)
 - [FP-A1] Proposed Public Right of Way (Location reference)
 - [PP-A1] Proposed Permissive Path (Location reference)
 - [A15] Proposed Alteration to Streets (Location reference)
 - [Yellow box] Formation of a new access/passing bay
 - [Purple line] Street Works (SW)
 - [SW73] Street Works (location reference)
 - [Orange line] Potential Claimed Public Right of Way

- NOTES:
- 1) ALL DIMENSIONS ARE IN METRES UNLESS STATED OTHERWISE.
 - 2) THE STREETS, RIGHTS OF WAY AND ACCESS PLANS SHOULD BE READ IN CONJUNCTION WITH THE DEVELOPMENT CONSENT ORDER (DCO) AND THE DOCUMENTS TO BE CERTIFIED UNDER IT, IN PARTICULAR PART 3 OF THE DCO AND SCHEDULES 4 - 7.
 - 3) FOR INFORMATION RELATING TO THE PROPOSED TEMPORARY TRAFFIC MANAGEMENT AND TRAFFIC REGULATION ORDERS PLEASE SEE TRAFFIC REGULATIONS PLAN.
 - 4) THE ORDER LIMITS HAS BEEN DRAWN TO THE LAND REGISTRY BOUNDARIES AND TOPOGRAPHICAL SURVEY DATA OF THE SITE. THE ACCURACY OF LAND REGISTRY AND THE TOPOGRAPHICAL SURVEY DIFFERS FROM THE OS BASE MAPPING WHICH RESULTS IN THE ORDER LIMITS NOT ALIGNING WITH THE LINE WORK SHOWN ON THE OS MAPPING.

KEY PLAN:

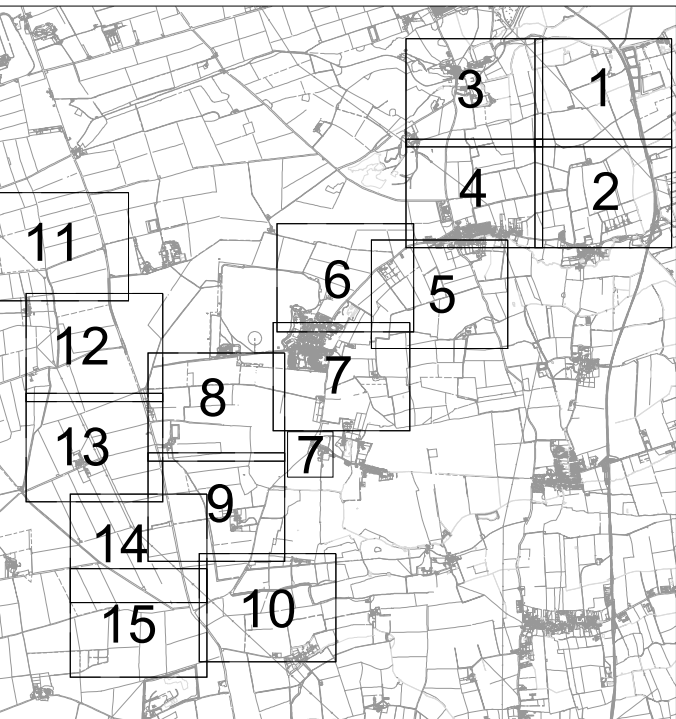

03	JUN 25	MINOR AMENDMENTS TO PROPOSED PATH EXTENTS	RSK	RSK	EDF
02	JAN 25	MINOR AMENDMENTS IN LINE WITH PINS GUIDANCE	RSK	RSK	EDF
01	NOV 24	DCO SUBMISSION	RSK	RSK	EDF

REVISION	DATE	DESCRIPTION	DRAWN	CHECKED	APPROVED
----------	------	-------------	-------	---------	----------

Springwell Solar Farm



DOCUMENT:
APPLICATION DRAWINGS FOR
APPROVAL REGULATION 5(2)(K)

DRAWING TITLE:
STREETS, RIGHTS OF WAY AND
ACCESS PLANS
KEY PLAN
SHEET 1 OF 1

PIN REFERENCE NO: EN010149/APP/2.4	REVISION: 03
---------------------------------------	-----------------

DATE: JUN 2025	DRAWN: RSK	SCALE: 1:20,000 at A1
-------------------	---------------	--------------------------



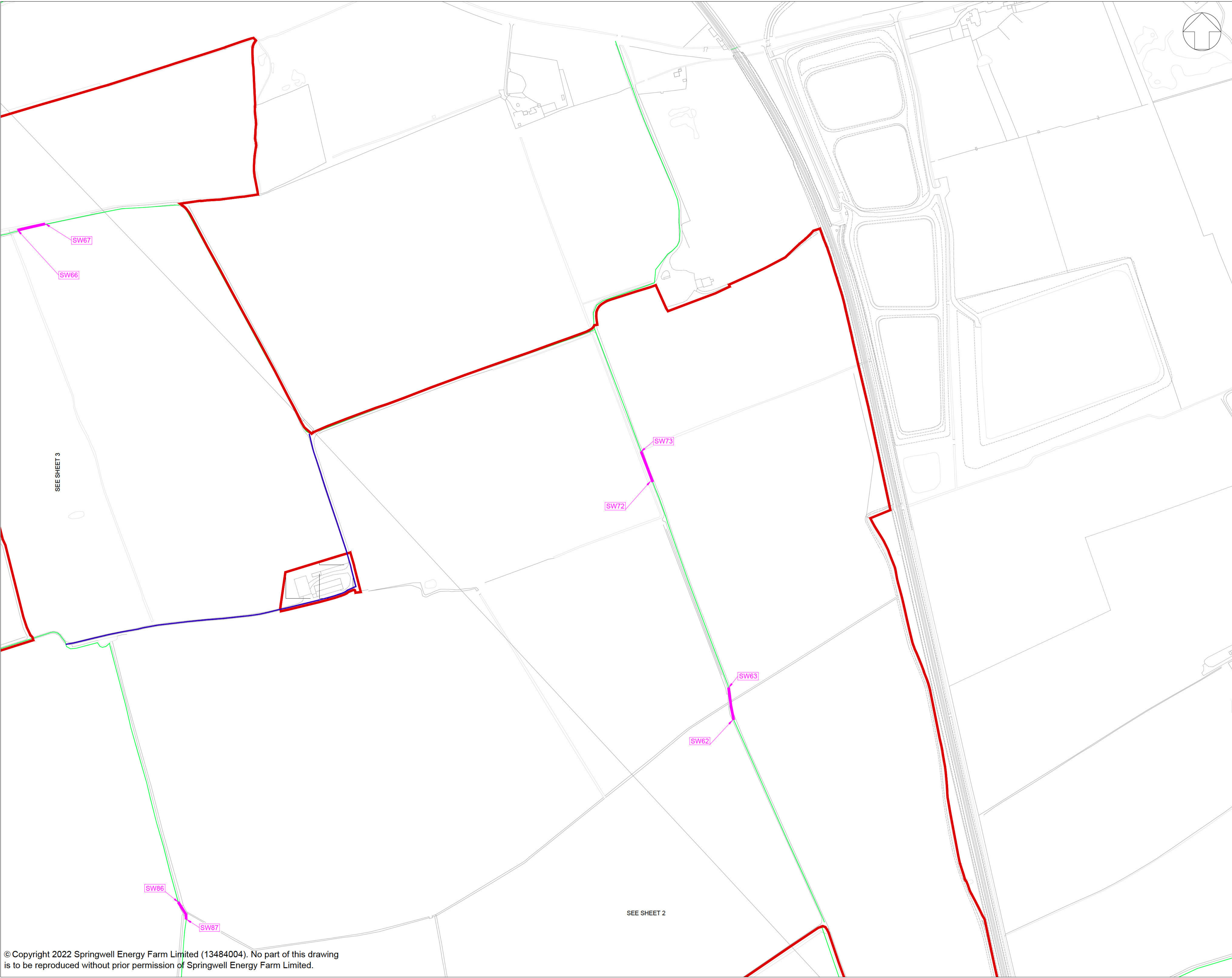

KEY:

- Order Limits
- Areas outside of order limits
- Existing Public Rights of Way (PROW)
- Existing Permissive Path (EP)
- Proposed Permissive Path (PP)
- Proposed Enhanced Public Right of Way (PE)
- Proposed Public Right of Way (FP)
- Formation of a new access/passing bay (Location reference)
- Extents of a new access/passing bay (Location reference)
- Proposed Enhanced Public Right of Way (Location reference)
- Proposed Public Right of Way (Location reference)
- Proposed Permissive Path (Location reference)
- Proposed Alteration to Streets (Location reference)
- Formation of a new access/passing bay
- Street Works (SW)
- Street Works (location reference)
- Potential Claimed Public Right of Way
- Potential Claimed Public Right of Way (location reference)

NOTES:

- ALL DIMENSIONS ARE IN METRES UNLESS STATED OTHERWISE.
- THE STREETS, RIGHTS OF WAY AND ACCESS PLANS SHOULD BE READ IN CONJUNCTION WITH THE DEVELOPMENT CONSENT ORDER (DCO) AND THE DOCUMENTS TO BE CERTIFIED UNDER IT, IN PARTICULAR PART 3 OF THE DCO AND SCHEDULES 4 - 7.
- FOR INFORMATION RELATING TO THE PROPOSED TEMPORARY TRAFFIC MANAGEMENT AND TRAFFIC REGULATION ORDERS PLEASE SEE TRAFFIC REGULATIONS PLAN.
- THE ORDER LIMITS HAS BEEN DRAWN TO THE LAND REGISTRY BOUNDARIES AND TOPOGRAPHICAL SURVEY DATA OF THE SITE. THE ACCURACY OF LAND REGISTRY AND THE TOPOGRAPHICAL SURVEY DIFFERS FROM THE OS BASE MAPPING WHICH RESULTS IN THE ORDER LIMITS NOT ALIGNING WITH THE LINE WORK SHOWN ON THE OS MAPPING.

KEY PLAN:

02	JAN 25	MINOR AMENDMENTS IN LINE WITH PINS GUIDANCE	RSK	RSK	EDF
01	NOV 24	DCO SUBMISSION	RSK	RSK	EDF
REVISION	DATE	DESCRIPTION	DRAWN	CHECKED	APPROVED

Springwell Solar Farm

DOCUMENT:
APPLICATION DRAWINGS FOR APPROVAL REGULATION 5(2)(k)

DRAWING TITLE:
**STREETS, RIGHTS OF WAY AND ACCESS PLANS
SHEET 1 OF 15**

PIN REFERENCE NO:
EN010149/APP/2.4

REVISION:
02

DATE:
Jan 2025

DRAWN:
RSK

SCALE:
1:2,500 at A1

SCALE BAR:

© Copyright 2022 Springwell Energy Farm Limited (13484004). No part of this drawing is to be reproduced without prior permission of Springwell Energy Farm Limited.

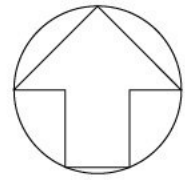
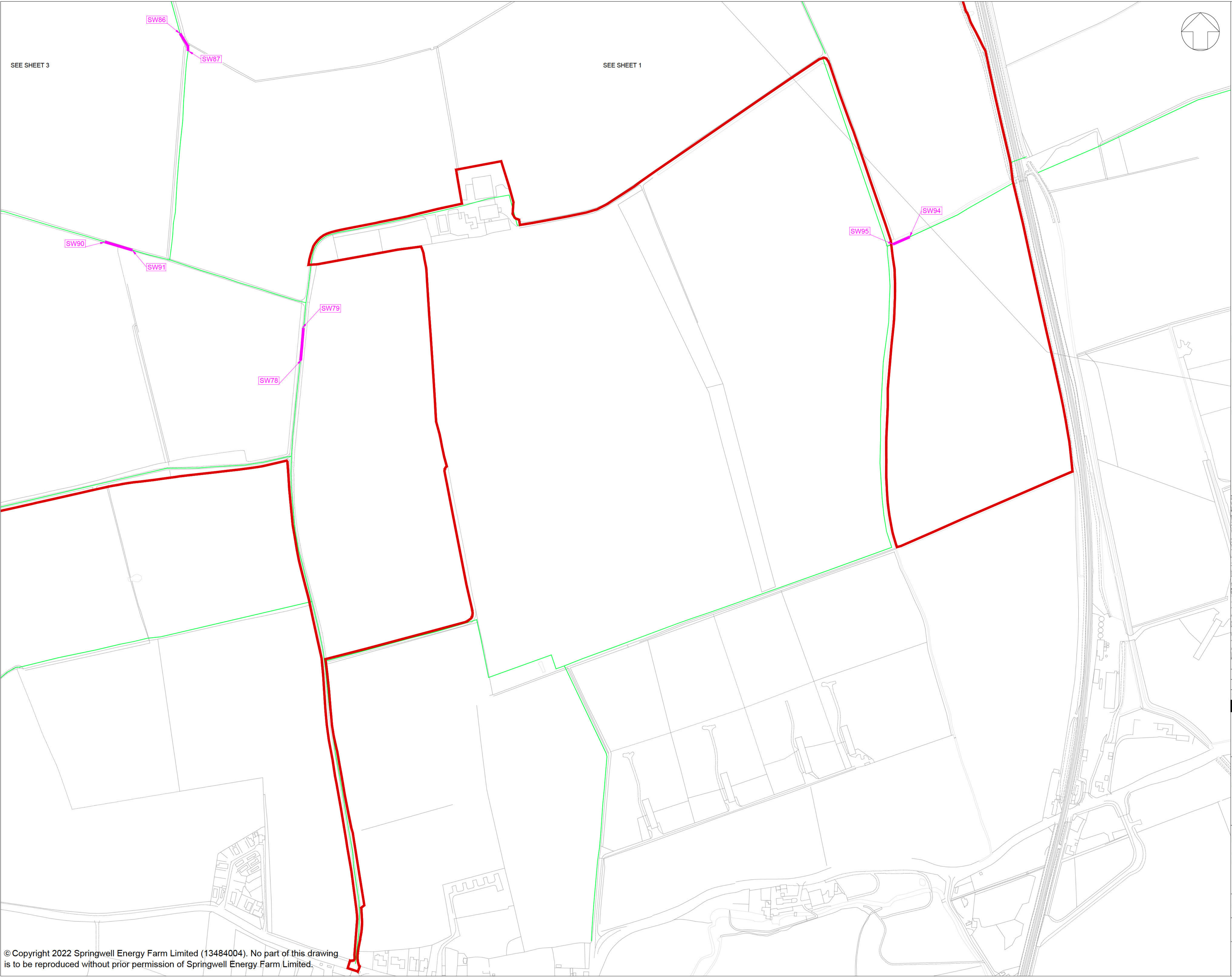

- KEY:**
- Order Limits
 - Areas outside of order limits
 - Existing Public Rights of Way (PROW)
 - Existing Permissive Path (EP)
 - Proposed Permissive Path (PP)
 - Proposed Enhanced Public Right of Way (PE)
 - Proposed Public Right of Way (FP)
 - Formation of a new access/passing bay (Location reference)
 - Extents of a new access/passing bay (Location reference)
 - Proposed Enhanced Public Right of Way (Location reference)
 - Proposed Public Right of Way (Location reference)
 - Proposed Permissive Path (Location reference)
 - Proposed Alteration to Streets (Location reference)
 - Formation of a new access/passing bay
 - Street Works (SW)
 - Street Works (location reference)
 - Potential Claimed Public Right of Way
 - Potential Claimed Public Right of Way (location reference)

- NOTES:**
- 1) ALL DIMENSIONS ARE IN METRES UNLESS STATED OTHERWISE.
 - 2) THE STREETS, RIGHTS OF WAY AND ACCESS PLANS SHOULD BE READ IN CONJUNCTION WITH THE DEVELOPMENT CONSENT ORDER (DCO) AND THE DOCUMENTS TO BE CERTIFIED UNDER IT, IN PARTICULAR PART 3 OF THE DCO AND SCHEDULES 4 - 7.
 - 3) FOR INFORMATION RELATING TO THE PROPOSED TEMPORARY TRAFFIC MANAGEMENT AND TRAFFIC REGULATION ORDERS PLEASE SEE TRAFFIC REGULATIONS PLAN.
 - 4) THE ORDER LIMITS HAS BEEN DRAWN TO THE LAND REGISTRY BOUNDARIES AND TOPOGRAPHICAL SURVEY DATA OF THE SITE. THE ACCURACY OF LAND REGISTRY AND THE TOPOGRAPHICAL SURVEY DIFFERS FROM THE OS BASE MAPPING WHICH RESULTS IN THE ORDER LIMITS NOT ALIGNING WITH THE LINE WORK SHOWN ON THE OS MAPPING.

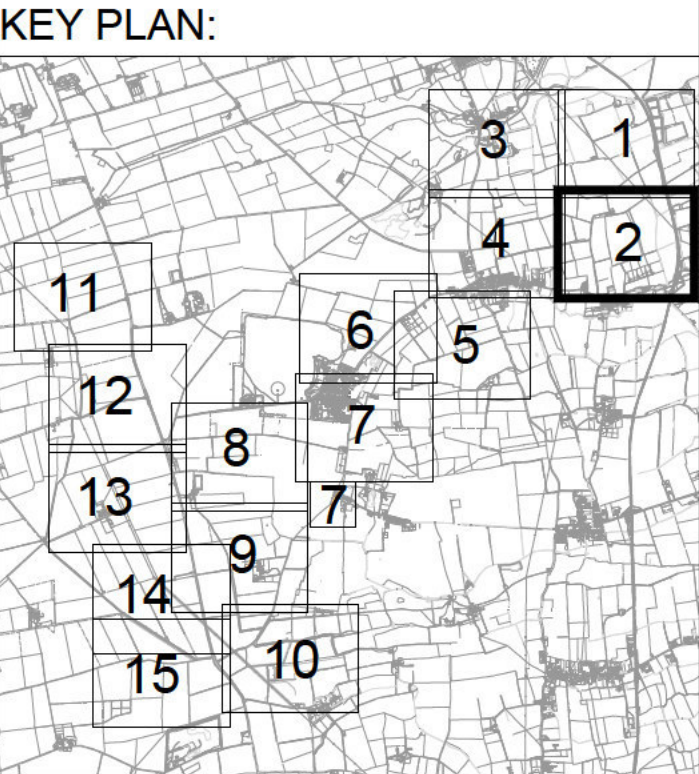

02	JAN 25	MINOR AMENDMENTS IN LINE WITH PINS GUIDANCE	RSK	RSK	EDF
01	NOV 24	DCO SUBMISSION	RSK	RSK	EDF
REVISION	DATE	DESCRIPTION	DRAWN	CHECKED	APPROVED

Springwell Solar Farm



DOCUMENT:
APPLICATION DRAWINGS FOR
APPROVAL REGULATION 5(2)(k)

DRAWING TITLE:
STREETS, RIGHTS OF WAY AND
ACCESS PLANS
SHEET 2 OF 15

PIN REFERENCE NO:
END010149/APP/2.4

REVISION:
02

DATE:
JAN 2025

DRAWN:
RSK

SCALE:
1:2,500 at A1



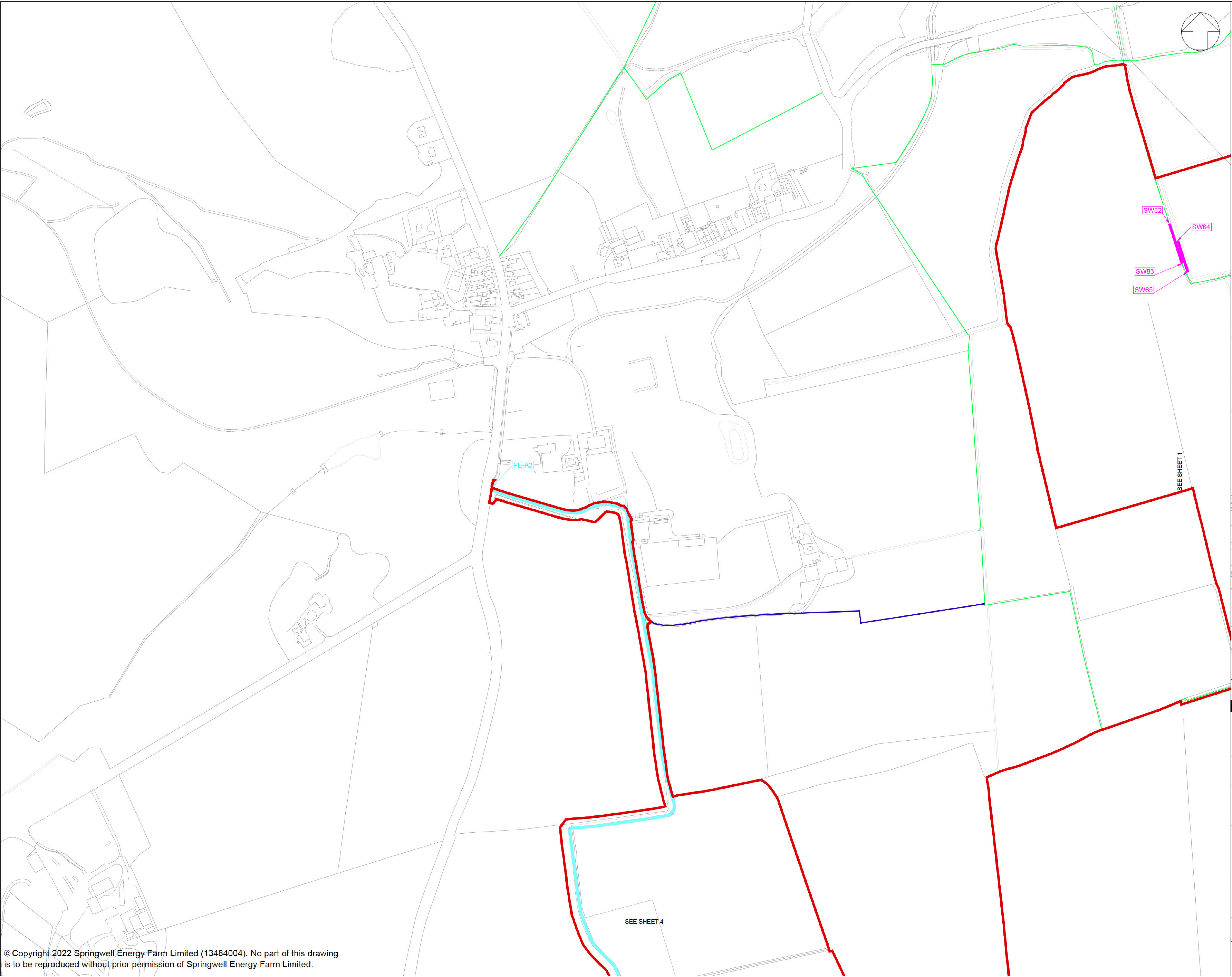

KEY:

- Order Limits
- Areas outside of order limits
- Existing Public Rights of Way (PROW)
- Existing Permissive Path (EP)
- Proposed Permissive Path (PP)
- Proposed Enhanced Public Right of Way (PE)
- Proposed Public Right of Way (FP)
- Formation of a new access/passing bay (Location reference)
- Extents of a new access/passing bay (Location reference)
- Proposed Enhanced Public Right of Way (Location reference)
- Proposed Public Right of Way (Location reference)
- Proposed Permissive Path (Location reference)
- Proposed Alteration to Streets (Location reference)
- Formation of a new access/passing bay
- Street Works (SW)
- Street Works (location reference)
- Potential Claimed Public Right of Way
- Potential Claimed Public Right of Way (location reference)

NOTES:

1) ALL DIMENSIONS ARE IN METRES UNLESS STATED OTHERWISE.

2) THE STREETS, RIGHTS OF WAY AND ACCESS PLANS SHOULD BE READ IN CONJUNCTION WITH THE DEVELOPMENT CONSENT ORDER (DCO) AND THE DOCUMENTS TO BE CERTIFIED UNDER IT, IN PARTICULAR PART 3 OF THE DCO AND SCHEDULES 4 - 7.

3) FOR INFORMATION RELATING TO THE PROPOSED TEMPORARY TRAFFIC MANAGEMENT AND TRAFFIC REGULATION ORDERS PLEASE SEE TRAFFIC REGULATIONS PLAN.

4) THE ORDER LIMITS HAS BEEN DRAWN TO THE LAND REGISTRY BOUNDARIES AND TOPOGRAPHICAL SURVEY DATA OF THE SITE. THE ACCURACY OF LAND REGISTRY AND THE TOPOGRAPHICAL SURVEY DIFFERS FROM THE OS BASE MAPPING WHICH RESULTS IN THE ORDER LIMITS NOT ALIGNING WITH THE LINE WORK SHOWN ON THE OS MAPPING.

KEY PLAN:

02	JAN 25	M NOR AMENDMENTS IN LINE WITH PINS GUIDANCE	RSK	RSK	EDF
01	NOV 24	DCO SUBMISSION	RSK	RSK	EDF
REVISION	DATE	DESCRIPTION	DRAWN	CHECKED	APPROVED

Springwell Solar Farm

DOCUMENT:
APPLICATION DRAWINGS FOR APPROVAL REGULATION 5(2)(k)

DRAWING TITLE:
**STREETS, RIGHTS OF WAY AND ACCESS PLANS
SHEET 3 OF 15**

PIN REFERENCE NO:
EN010149/APP/2.4

REVISION:
02

DATE:
JAN 2025

DRAWN:
RSK

SCALE:
1:2,500 at A1

SCALE BAR:

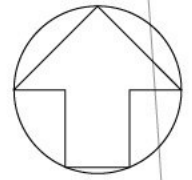
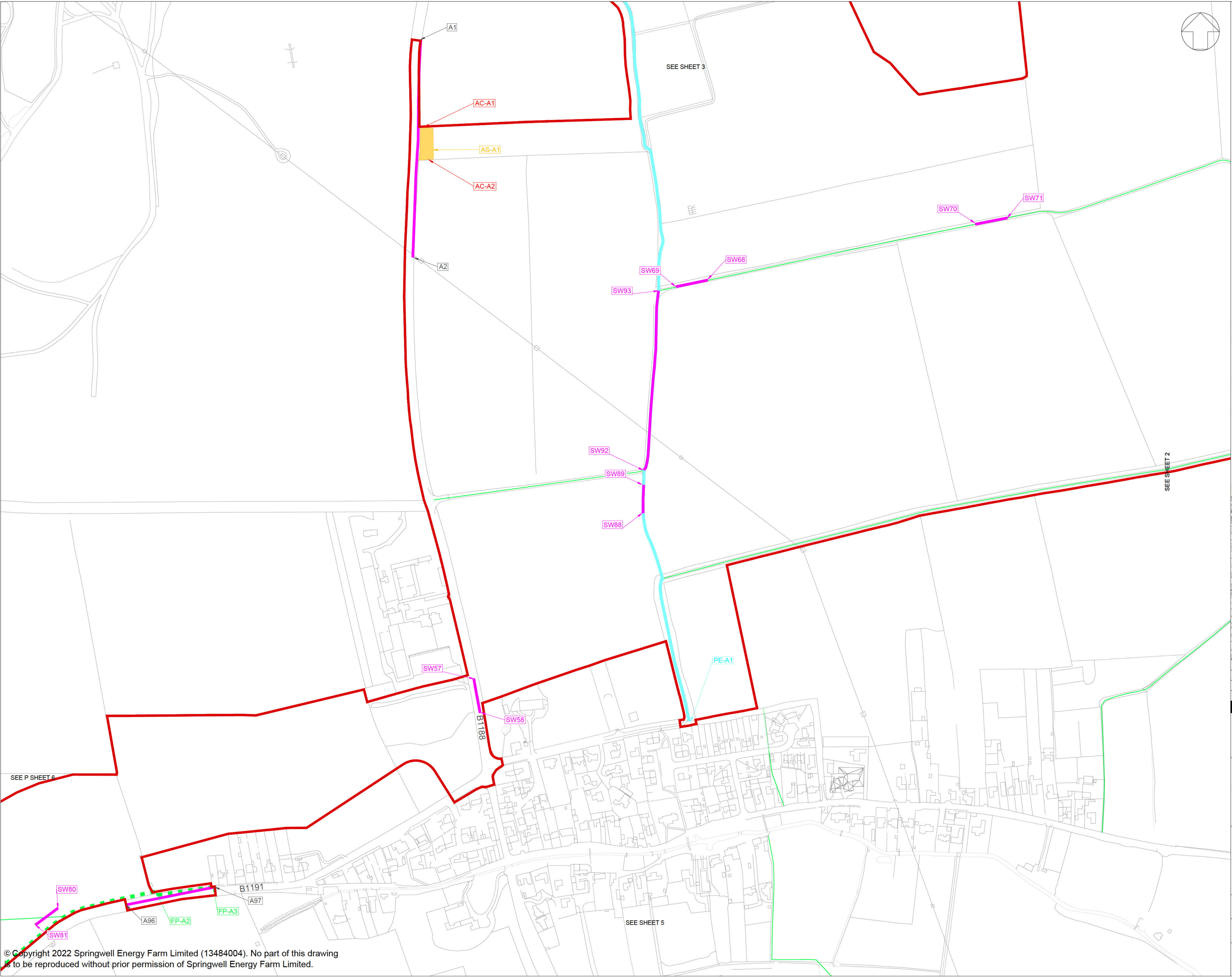

- KEY:**
- Order Limits
 - Areas outside of order limits
 - Existing Public Rights of Way (PROW)
 - Existing Permissive Path (EP)
 - Proposed Permissive Path (PP)
 - Proposed Enhanced Public Right of Way (PE)
 - Proposed Public Right of Way (FP)
 - Formation of a new access/passing bay (Location reference)
 - Extents of a new access/passing bay (Location reference)
 - Proposed Enhanced Public Right of Way (Location reference)
 - Proposed Public Right of Way (Location reference)
 - Proposed Permissive Path (Location reference)
 - Proposed Alteration to Streets (Location reference)
 - Formation of a new access/passing bay
 - Street Works (SW)
 - Street Works (location reference)
 - Potential Claimed Public Right of Way
 - Potential Claimed Public Right of Way (location reference)

- NOTES:**
- 1) ALL DIMENSIONS ARE IN METRES UNLESS STATED OTHERWISE.
 - 2) THE STREETS, RIGHTS OF WAY AND ACCESS PLANS SHOULD BE READ IN CONJUNCTION WITH THE DEVELOPMENT CONSENT ORDER (DCO) AND THE DOCUMENTS TO BE CERTIFIED UNDER IT, IN PARTICULAR PART 3 OF THE DCO AND SCHEDULES 4 - 7.
 - 3) FOR INFORMATION RELATING TO THE PROPOSED TEMPORARY TRAFFIC MANAGEMENT AND TRAFFIC REGULATION ORDERS PLEASE SEE TRAFFIC REGULATIONS PLAN.
 - 4) THE ORDER LIMITS HAS BEEN DRAWN TO THE LAND REGISTRY BOUNDARIES AND TOPOGRAPHICAL SURVEY DATA OF THE SITE. THE ACCURACY OF LAND REGISTRY AND THE TOPOGRAPHICAL SURVEY DIFFERS FROM THE OS BASE MAPPING WHICH RESULTS IN THE ORDER LIMITS NOT ALIGNING WITH THE LINE WORK SHOWN ON THE OS MAPPING.

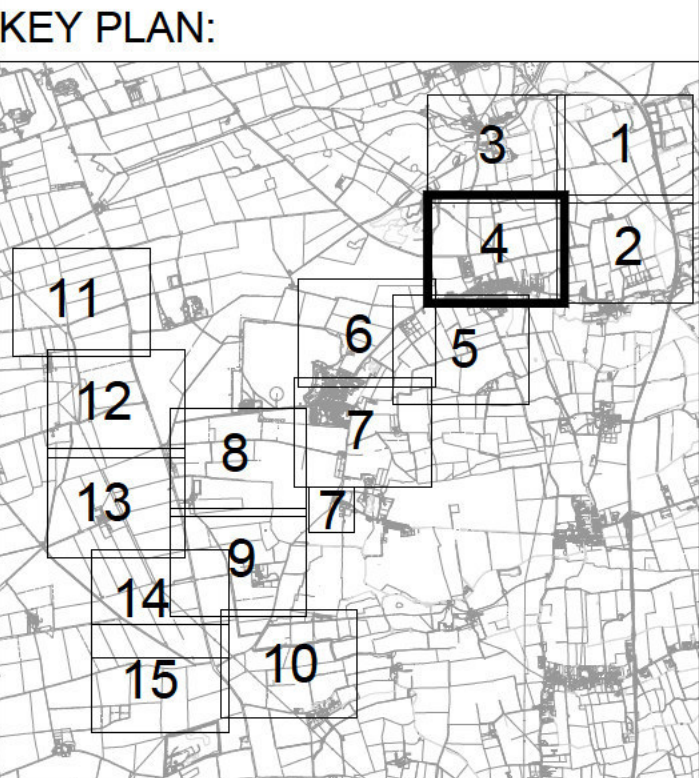

02	JAN 25	MINOR AMENDMENTS IN LINE WITH PINS GUIDANCE	RSK	RSK	EDF
01	NOV 24	DCO SUBMISSION	RSK	RSK	EDF
REVISION	DATE	DESCRIPTION	DRAWN	CHECKED	APPROVED

Springwell Solar Farm



DOCUMENT:
APPLICATION DRAWINGS FOR
APPROVAL REGULATION 5(2)(K)

DRAWING TITLE:
STREETS, RIGHTS OF WAY AND
ACCESS PLANS
SHEET 4 OF 15

PIN REFERENCE NO:
EN010149/APP/2.4

REVISION:
02

DATE:
JAN 2025

DRAWN:
RSK

SCALE:
1:2,500 at A1



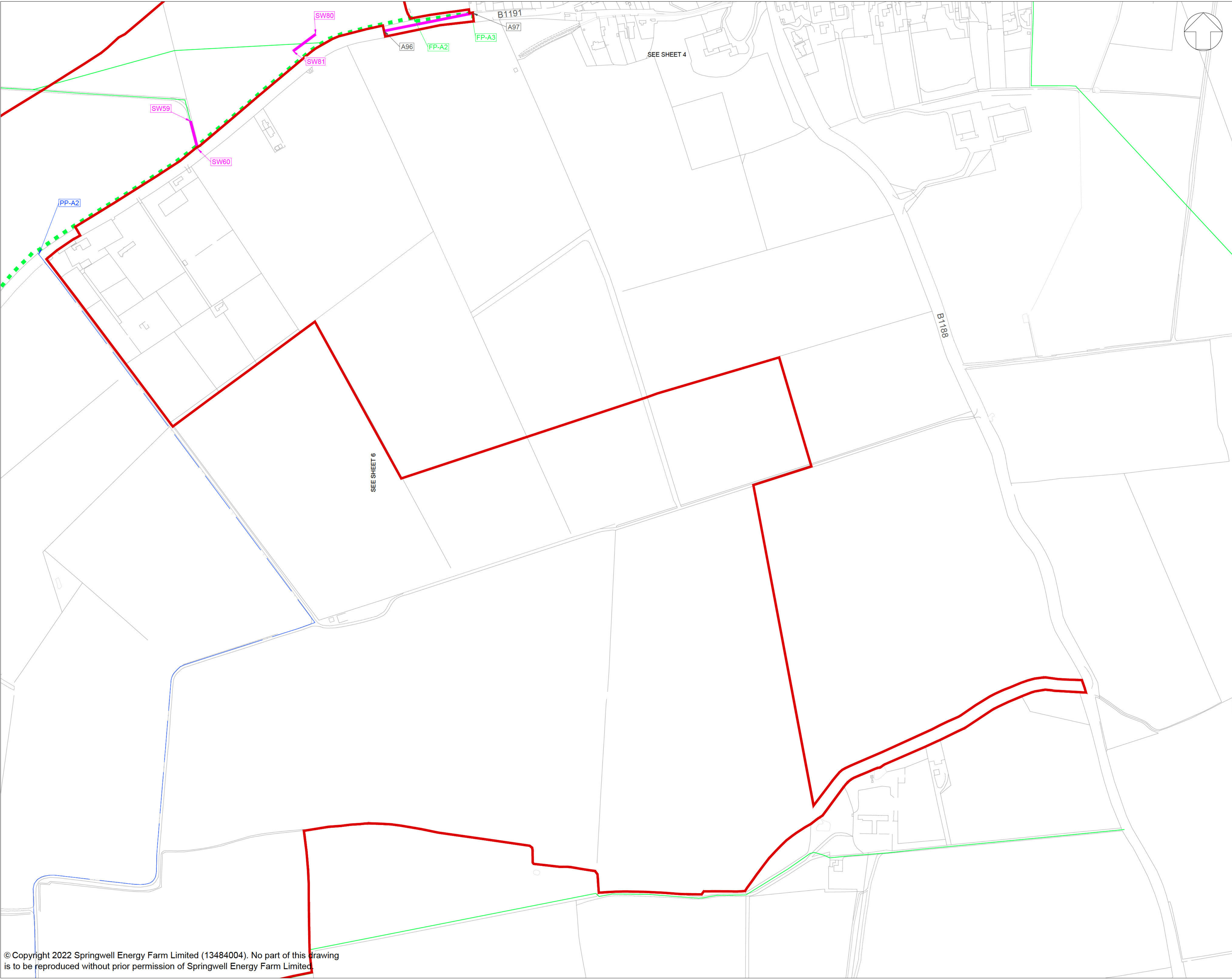

KEY:

- Order Limits
- Areas outside of order limits
- Existing Public Rights of Way (PROW)
- Existing Permissive Path (EP)
- Proposed Permissive Path (PP)
- Proposed Enhanced Public Right of Way (PE)
- Proposed Public Right of Way (FP)
- AS-A1 Formation of a new access/passing bay (Location reference)
- AC-A2 Extents of a new access/passing bay (Location reference)
- PE-A1 Proposed Enhanced Public Right of Way (Location reference)
- FP-A1 Proposed Public Right of Way (Location reference)
- PP-A1 Proposed Permissive Path (Location reference)
- A15 Proposed Alteration to Streets (Location reference)
- Formation of a new access/passing bay
- Street Works (SW)
- SW73 Street Works (location reference)
- Potential Claimed Public Right of Way
- PC-A1 Potential Claimed Public Right of Way (location reference)

NOTES:

- 1) ALL DIMENSIONS ARE IN METRES UNLESS STATED OTHERWISE.
- 2) THE STREETS, RIGHTS OF WAY AND ACCESS PLANS SHOULD BE READ IN CONJUNCTION WITH THE DEVELOPMENT CONSENT ORDER (DCO) AND THE DOCUMENTS TO BE CERTIFIED UNDER IT, IN PARTICULAR PART 3 OF THE DCO AND SCHEDULES 4 - 7.
- 3) FOR INFORMATION RELATING TO THE PROPOSED TEMPORARY TRAFFIC MANAGEMENT AND TRAFFIC REGULATION ORDERS PLEASE SEE TRAFFIC REGULATIONS PLAN.
- 4) THE ORDER LIMITS HAS BEEN DRAWN TO THE LAND REGISTRY BOUNDARIES AND TOPOGRAPHICAL SURVEY DATA OF THE SITE. THE ACCURACY OF LAND REGISTRY AND THE TOPOGRAPHICAL SURVEY DIFFERS FROM THE OS BASE MAPPING WHICH RESULTS IN THE ORDER LIMITS NOT ALIGNING WITH THE LINE WORK SHOWN ON THE OS MAPPING.

KEY PLAN:

02	JAN 25	MINOR AMENDMENTS N/L NE WITH PINS GU DANCE	RSK	RSK	EDF
01	NOV 24	DCO SUBMISSION	RSK	RSK	EDF
REVISION	DATE	DESCRIPTION	DRAWN	CHECKED	APPROVED

Springwell Solar Farm

DOCUMENT:

APPLICATION DRAWINGS FOR APPROVAL REGULATION 5(2)(k)

DRAWING TITLE:

STREETS, RIGHTS OF WAY AND ACCESS PLANS

SHEET 5 OF 15

PIN REFERENCE NO:
EN010149/APP/2.4

REVISION:
02

DATE:
JAN 2025

DRAWN:
RSK

SCALE:
1:2,500 at A1

SCALE BAR:

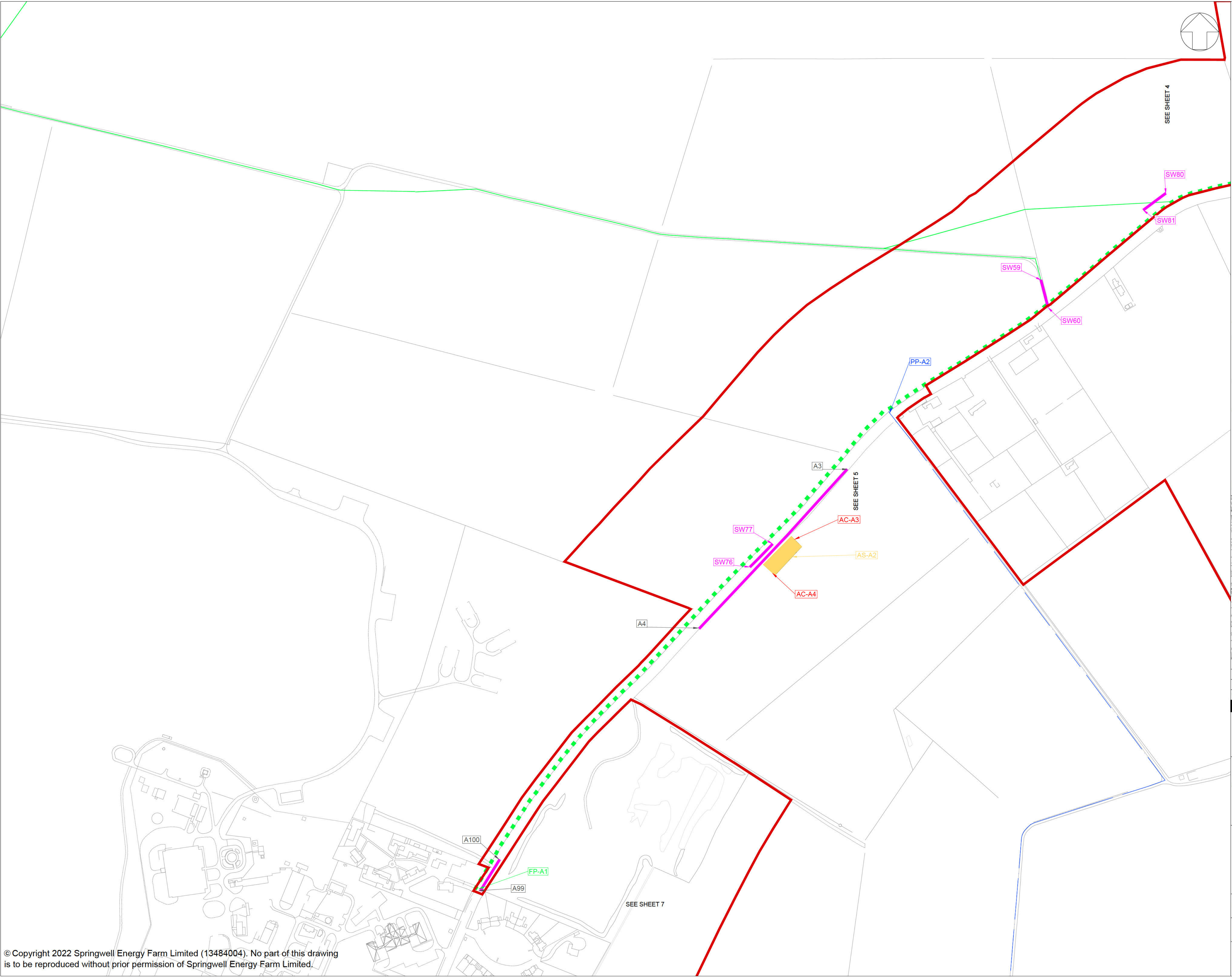

KEY:

- Order Limits
- Areas outside of order limits
- Existing Public Rights of Way (PROW)
- Existing Permissive Path (EP)
- Proposed Permissive Path (PP)
- Proposed Enhanced Public Right of Way (PE)
- Proposed Public Right of Way (FP)
- Formation of a new access/passing bay (Location reference)
- Extents of a new access/passing bay (Location reference)
- Proposed Enhanced Public Right of Way (Location reference)
- Proposed Public Right of Way (Location reference)
- Proposed Permissive Path (Location reference)
- Proposed Alteration to Streets (Location reference)
- Formation of a new access/passing bay
- Street Works (SW)
- Street Works (location reference)
- Potential Claimed Public Right of Way
- Potential Claimed Public Right of Way (location reference)

- NOTES:**
- 1) ALL DIMENSIONS ARE IN METRES UNLESS STATED OTHERWISE.
 - 2) THE STREETS, RIGHTS OF WAY AND ACCESS PLANS SHOULD BE READ IN CONJUNCTION WITH THE DEVELOPMENT CONSENT ORDER (DCO) AND THE DOCUMENTS TO BE CERTIFIED UNDER IT, IN PARTICULAR PART 3 OF THE DCO AND SCHEDULES 4 - 7.
 - 3) FOR INFORMATION RELATING TO THE PROPOSED TEMPORARY TRAFFIC MANAGEMENT AND TRAFFIC REGULATION ORDERS PLEASE SEE TRAFFIC REGULATIONS PLAN.
 - 4) THE ORDER LIMITS HAS BEEN DRAWN TO THE LAND REGISTRY BOUNDARIES AND TOPOGRAPHICAL SURVEY DATA OF THE SITE. THE ACCURACY OF LAND REGISTRY AND THE TOPOGRAPHICAL SURVEY DIFFERS FROM THE OS BASE MAPPING WHICH RESULTS IN THE ORDER LIMITS NOT ALIGNING WITH THE LINE WORK SHOWN ON THE OS MAPPING.

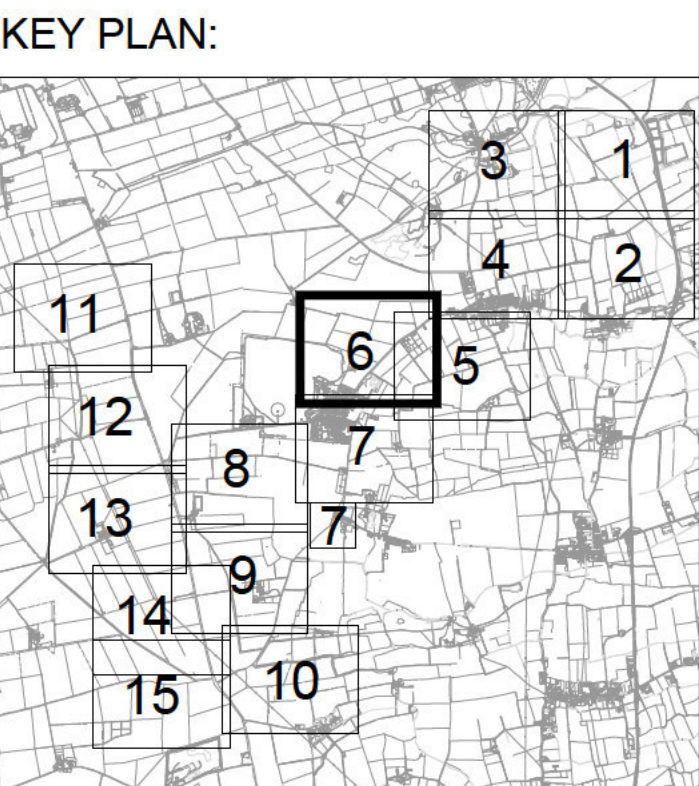

02	JAN 25	M NOR AMENDMENTS IN LINE WITH PINS GUIDANCE	RSK	RSK	EDF
01	NOV 24	DCO SUBMISSION	RSK	RSK	EDF
REVISION	DATE	DESCRIPTION	DRAWN	CHECKED	APPROVED

Springwell Solar Farm

DOCUMENT:
APPLICATION DRAWINGS FOR APPROVAL REGULATION 5(2)(k)

DRAWING TITLE
**STREETS, RIGHTS OF WAY AND ACCESS PLANS
SHEET 6 OF 15**

PIN REFERENCE NO
EN010149/APP2.4

REVISION:
02

DATE:
JAN 2025

DRAWN:
RSK

SCALE:
1:2,500 at A1



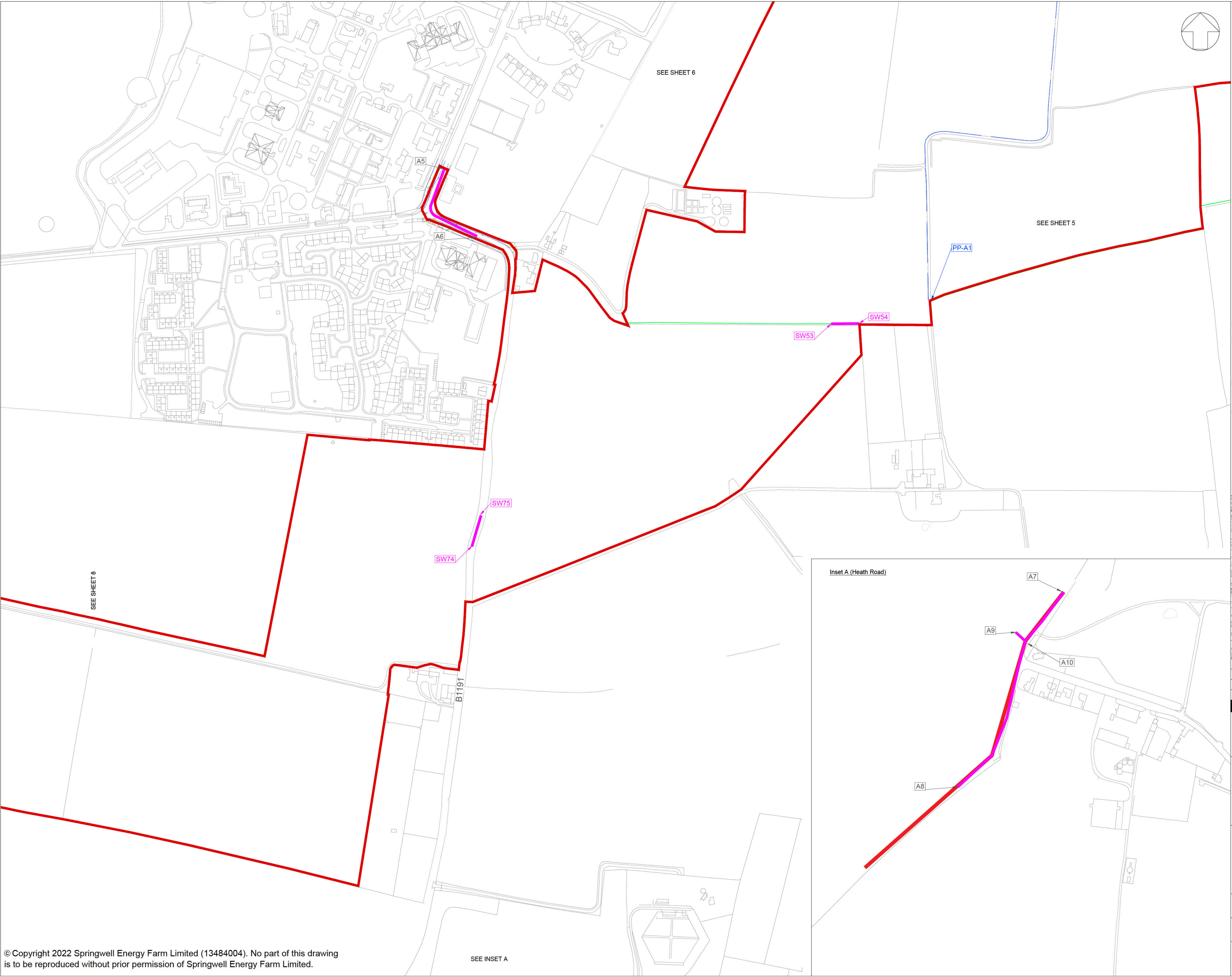

KEY:

Order Limits

Areas outside of order limits

Existing Public Rights of Way (PROW)

Existing Permissive Path (EP)

Proposed Permissive Path (PP)

Proposed Enhanced Public Right of Way (PE)

Proposed Public Right of Way (FP)

AS-A1

Formation of a new access/passing bay (Location reference)

AC-A2

Extents of a new access/passing bay (Location reference)

PE-A1

Proposed Enhanced Public Right of Way (Location reference)

FP-A1

Proposed Public Right of Way (Location reference)

PP-A1

Proposed Permissive Path (Location reference)

A15

Proposed Alteration to Streets (Location reference)

Formation of a new access/passing bay

Street Works (SW)

SW73

Street Works (location reference)

Potential Claimed Public Right of Way

PC-A1

Potential Claimed Public Right of Way (location reference)

NOTES:

1) ALL DIMENSIONS ARE IN METRES UNLESS STATED OTHERWISE.

2) THE STREETS, RIGHTS OF WAY AND ACCESS PLANS SHOULD BE READ IN CONJUNCTION WITH THE DEVELOPMENT CONSENT ORDER (DCO) AND THE DOCUMENTS TO BE CERTIFIED UNDER IT, IN PARTICULAR PART 3 OF THE DCO AND SCHEDULES 4 - 7.

3) FOR INFORMATION RELATING TO THE PROPOSED TEMPORARY TRAFFIC MANAGEMENT AND TRAFFIC REGULATION ORDERS PLEASE SEE TRAFFIC REGULATIONS PLAN.

4) THE ORDER LIMITS HAS BEEN DRAWN TO THE LAND REGISTRY BOUNDARIES AND TOPOGRAPHICAL SURVEY DATA OF THE SITE. THE ACCURACY OF LAND REGISTRY AND THE TOPOGRAPHICAL SURVEY DIFFERS FROM THE OS BASE MAPPING WHICH RESULTS IN THE ORDER LIMITS NOT ALIGNING WITH THE LINE WORK SHOWN ON THE OS MAPPING.

KEY PLAN:

02	JAN 25	M NOR AMENDMENTS IN LINE WITH PINS GUIDANCE	RSK	RSK	EDF
01	NOV 24	DCO SUBMISSION	RSK	RSK	EDF
REVISION	DATE	DESCRIPTION	DRAWN	CHECKED	APPROVED

Springwell Solar Farm

DOCUMENT:
APPLICATION DRAWINGS FOR APPROVAL REGULATION 5(2)(k)

DRAWING TITLE:
STREETS, RIGHTS OF WAY AND ACCESS PLANS
SHEET 7 OF 15

PIN REFERENCE NO:
EN010145/APP2.4

REVISION:
02

DATE:
JAN 2025

DRAWN:
RSK

SCALE:
1:2,500 at A1

SCALE BAR:

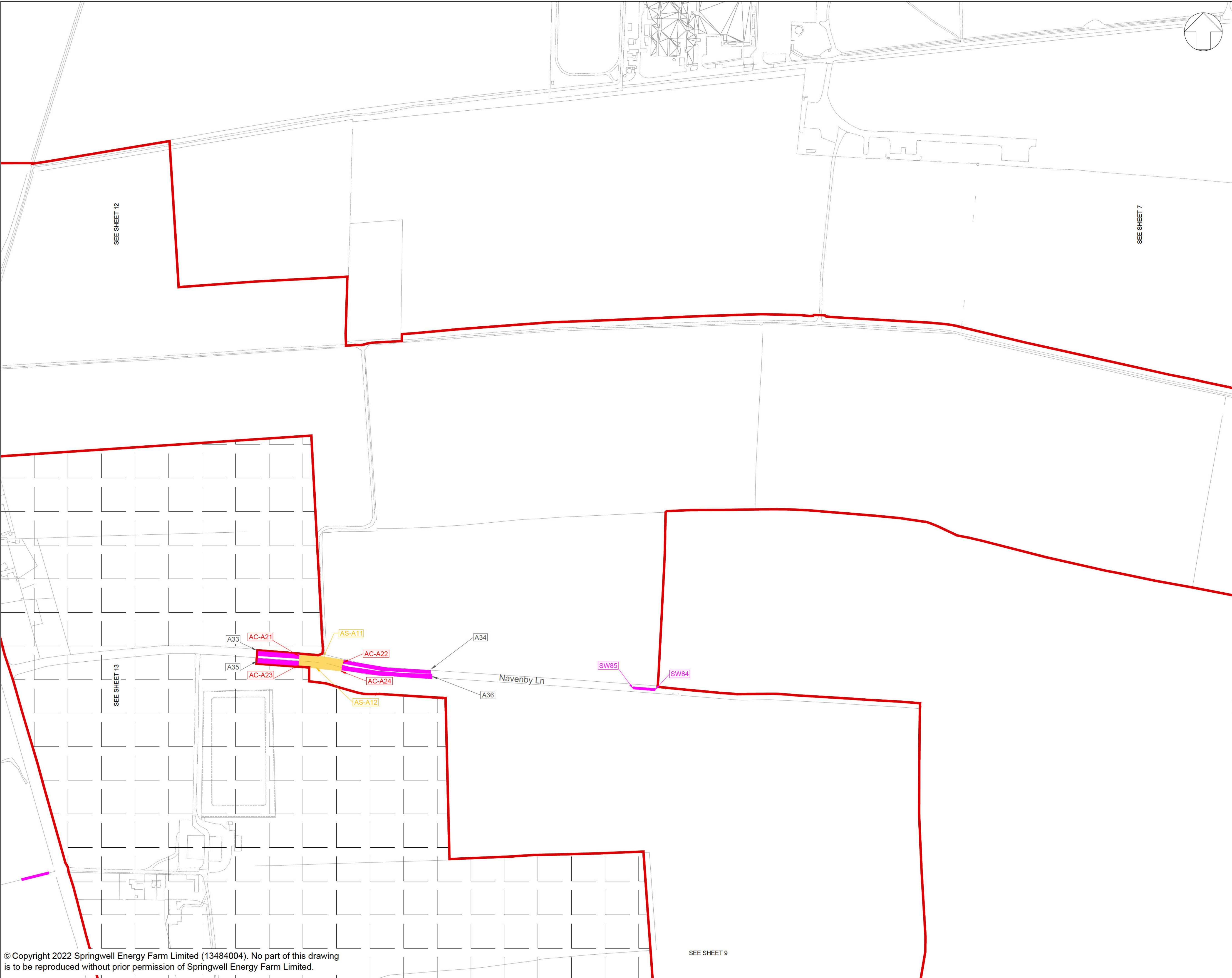

KEY:

	Order Limits
	Areas outside of order limits
	Existing Public Rights of Way (PROW)
	Existing Permissive Path (EP)
	Proposed Permissive Path (PP)
	Proposed Enhanced Public Right of Way (PE)
	Proposed Public Right of Way (FP)
	Formation of a new access/passing bay (Location reference)
	Extents of a new access/passing bay (Location reference)
	Proposed Enhanced Public Right of Way (Location reference)
	Proposed Public Right of Way (Location reference)
	Proposed Permissive Path (Location reference)
	Proposed Alteration to Streets (Location reference)
	Formation of a new access/passing bay
	Street Works (SW)
	Street Works (location reference)
	Potential Claimed Public Right of Way
	Potential Claimed Public Right of Way (location reference)

NOTES:

- 1) ALL DIMENSIONS ARE IN METRES UNLESS STATED OTHERWISE.
- 2) THE STREETS, RIGHTS OF WAY AND ACCESS PLANS SHOULD BE READ IN CONJUNCTION WITH THE DEVELOPMENT CONSENT ORDER (DCO) AND THE DOCUMENTS TO BE CERTIFIED UNDER IT, IN PARTICULAR PART 3 OF THE DCO AND SCHEDULES 4 - 7.
- 3) FOR INFORMATION RELATING TO THE PROPOSED TEMPORARY TRAFFIC MANAGEMENT AND TRAFFIC REGULATION ORDERS PLEASE SEE TRAFFIC REGULATIONS PLAN.
- 4) THE ORDER LIMITS HAS BEEN DRAWN TO THE LAND REGISTRY BOUNDARIES AND TOPOGRAPHICAL SURVEY DATA OF THE SITE. THE ACCURACY OF LAND REGISTRY AND THE TOPOGRAPHICAL SURVEY DIFFERS FROM THE OS BASE MAPPING WHICH RESULTS IN THE ORDER LIMITS NOT ALIGNING WITH THE LINE WORK SHOWN ON THE OS MAPPING.

KEY PLAN:

02	JAN 25	MINOR AMENDMENTS IN LINE WITH P.N.S. GUIDANCE	RSK	RSK	EDF
01	NOV 24	DCO SUBMISSION	RSK	RSK	EDF
REVISION	DATE	DESCRIPTION	DRAWN	CHECKED	APPROVED

Springwell Solar Farm

DOCUMENT:

APPLICATION DRAWINGS FOR APPROVAL REGULATION 5(2)(k)

DRAWING TITLE:

STREETS, RIGHTS OF WAY AND ACCESS PLANS

SHEET 8 OF 15

PIN REFERENCE NO: EN010149/APP2.4	REVISION: 02	
DATE: JAN 2025	DRAWN: RSK	SCALE: 1:2,500 at A1

SCALE BAR:

© Copyright 2022 Springwell Energy Farm Limited (13484004). No part of this drawing is to be reproduced without prior permission of Springwell Energy Farm Limited.

SEE SHEET 9

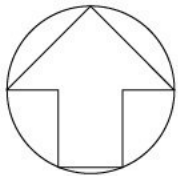
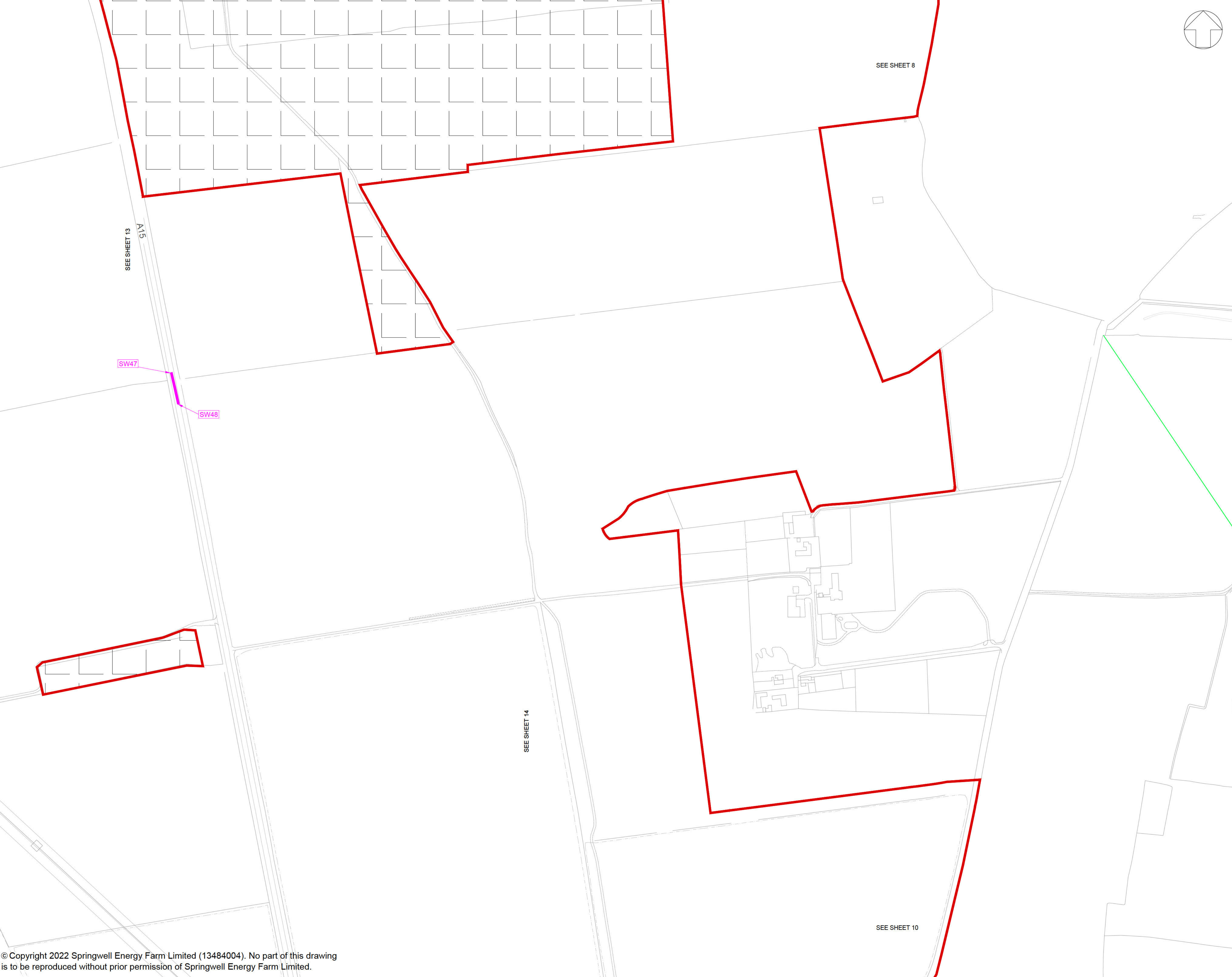

- KEY:**
- Order Limits
 - Areas outside of order limits
 - Existing Public Rights of Way (PROW)
 - Existing Permissive Path (EP)
 - Proposed Permissive Path (PP)
 - Proposed Enhanced Public Right of Way (PE)
 - Proposed Public Right of Way (FP)
 - AS-A1 Formation of a new access/passing bay (Location reference)
 - AC-A2 Extents of a new access/passing bay (Location reference)
 - PE-A1 Proposed Enhanced Public Right of Way (Location reference)
 - FP-A1 Proposed Public Right of Way (Location reference)
 - PP-A1 Proposed Permissive Path (Location reference)
 - A15 Proposed Alteration to Streets (Location reference)
 - Formation of a new access/passing bay
 - Street Works (SW)
 - SW73 Street Works (location reference)
 - Potential Claimed Public Right of Way
 - PC-A1 Potential Claimed Public Right of Way (location reference)

- NOTES:**
- 1) ALL DIMENSIONS ARE IN METRES UNLESS STATED OTHERWISE.
 - 2) THE STREETS, RIGHTS OF WAY AND ACCESS PLANS SHOULD BE READ IN CONJUNCTION WITH THE DEVELOPMENT CONSENT ORDER (DCO) AND THE DOCUMENTS TO BE CERTIFIED UNDER IT, IN PARTICULAR PART 3 OF THE DCO AND SCHEDULES 4 - 7.
 - 3) FOR INFORMATION RELATING TO THE PROPOSED TEMPORARY TRAFFIC MANAGEMENT AND TRAFFIC REGULATION ORDERS PLEASE SEE TRAFFIC REGULATIONS PLAN.
 - 4) THE ORDER LIMITS HAS BEEN DRAWN TO THE LAND REGISTRY BOUNDARIES AND TOPOGRAPHICAL SURVEY DATA OF THE SITE. THE ACCURACY OF LAND REGISTRY AND THE TOPOGRAPHICAL SURVEY DIFFERS FROM THE OS BASE MAPPING WHICH RESULTS IN THE ORDER LIMITS NOT ALIGNING WITH THE LINE WORK SHOWN ON THE OS MAPPING.

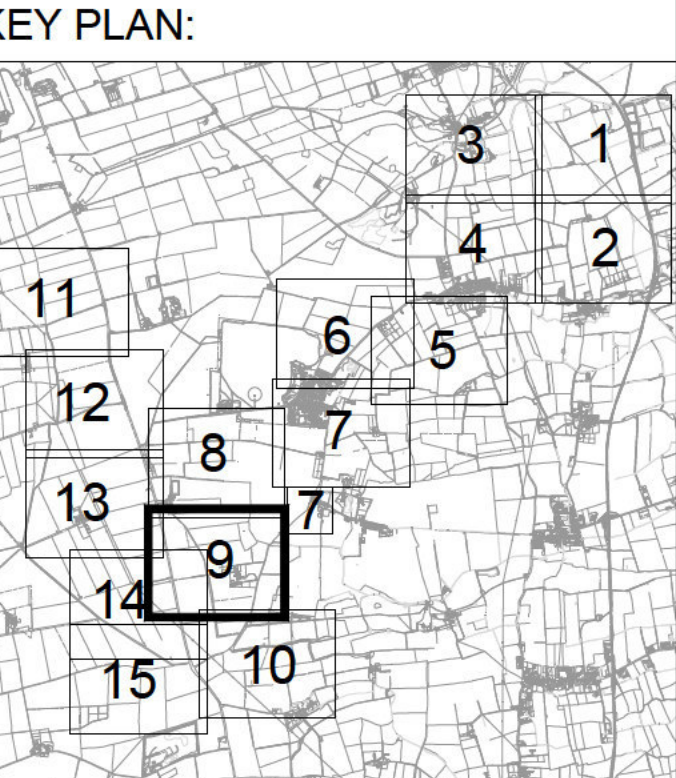

02	JAN 25	MINOR AMENDMENTS N LINE WITH PINS GU DANCE	RSK	RSK	EDF
01	NOV 24	DCO SUBMISSION	RSK	RSK	EDF
REVISION	DATE	DESCRIPTION	DRAWN	CHECKED	APPROVED

Springwell Solar Farm



DOCUMENT:
APPLICATION DRAWINGS FOR
APPROVAL REGULATION 5(2)(k)

DRAWING TITLE:
STREETS, RIGHTS OF WAY AND
ACCESS PLANS
SHEET 9 OF 15

PIN REFERENCE NO:
EN010149/APP/2.4

REVISION:
02

DATE:
JAN 2025

DRAWN:
RSK

SCALE:
1:2,500 at A1



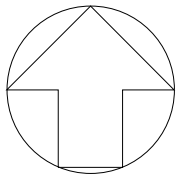
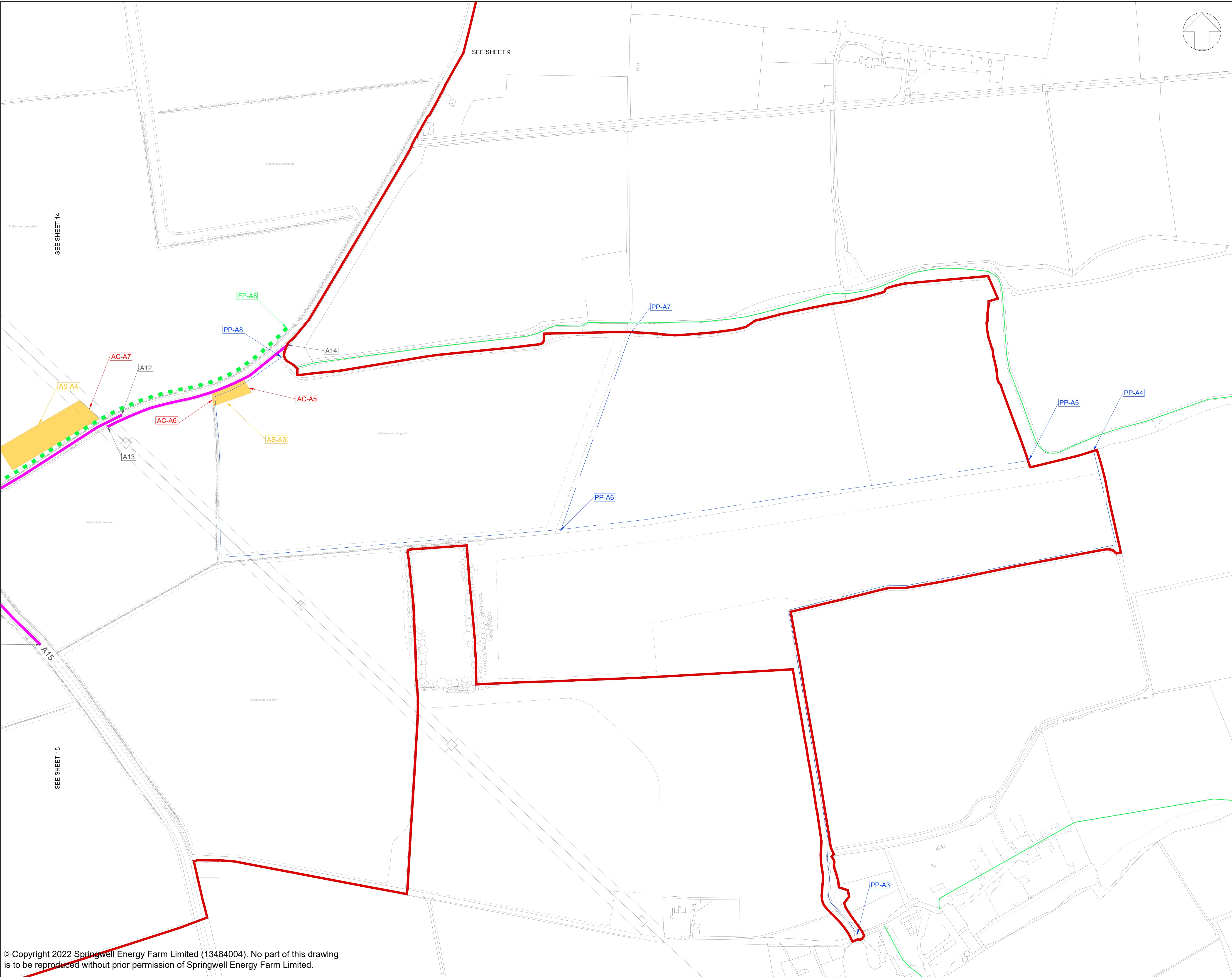

- KEY:**
- Order Limits
 - Areas outside of order limits
 - Existing Public Rights of Way (PROW)
 - Existing Permissive Path (EP)
 - Proposed Permissive Path (PP)
 - Proposed Enhanced Public Right of Way (PE)
 - Proposed Public Right of Way (FP)
 - Formation of a new access/passing bay (Location reference)
 - Extents of a new access/passing bay (Location reference)
 - Proposed Enhanced Public Right of Way (Location reference)
 - Proposed Public Right of Way (Location reference)
 - Proposed Permissive Path (Location reference)
 - Proposed Alteration to Streets (Location reference)
 - Formation of a new access/passing bay
 - Street Works (SW)
 - Street Works (location reference)
 - Potential Claimed Public Right of Way
 - Potential Claimed Public Right of Way (location reference)

- NOTES:**
- ALL DIMENSIONS ARE IN METRES UNLESS STATED OTHERWISE.
 - THE STREETS, RIGHTS OF WAY AND ACCESS PLANS SHOULD BE READ IN CONJUNCTION WITH THE DEVELOPMENT CONSENT ORDER (DCO) AND THE DOCUMENTS TO BE CERTIFIED UNDER IT, IN PARTICULAR PART 3 OF THE DCO AND SCHEDULES 4 - 7.
 - FOR INFORMATION RELATING TO THE PROPOSED TEMPORARY TRAFFIC MANAGEMENT AND TRAFFIC REGULATION ORDERS PLEASE SEE TRAFFIC REGULATIONS PLAN.
 - THE ORDER LIMITS HAS BEEN DRAWN TO THE LAND REGISTRY BOUNDARIES AND TOPOGRAPHICAL SURVEY DATA OF THE SITE. THE ACCURACY OF LAND REGISTRY AND THE TOPOGRAPHICAL SURVEY DIFFERS FROM THE OS BASE MAPPING WHICH RESULTS IN THE ORDER LIMITS NOT ALIGNING WITH THE LINE WORK SHOWN ON THE OS MAPPING.

KEY PLAN:

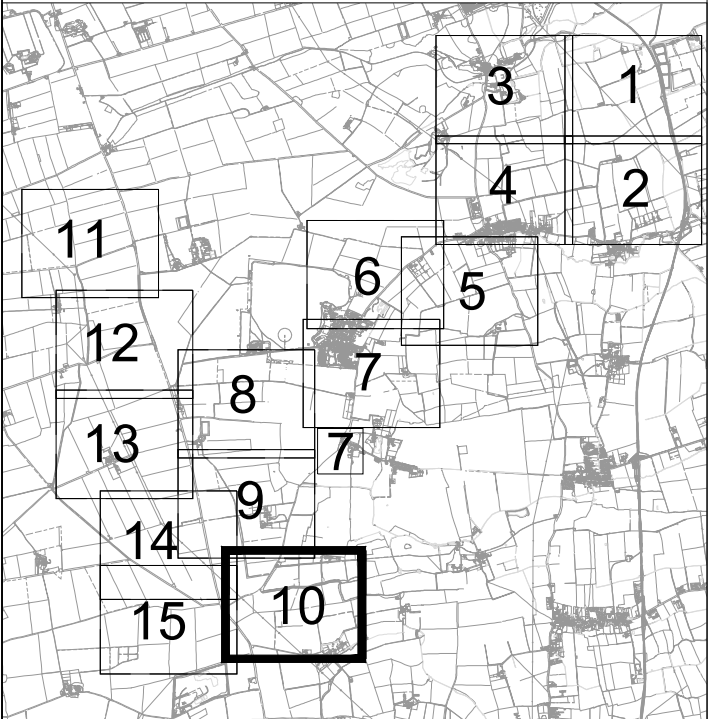

03	JUN 25	MINOR AMENDMENTS TO PROPOSED PATH EXTENTS	RSK	RSK	EDF
02	JAN 25	MINOR AMENDMENTS IN LINE WITH PINS GUIDANCE	RSK	RSK	EDF
01	NOV 24	DCO SUBMISSION	RSK	RSK	EDF
REVISION	DATE	DESCRIPTION	DRAWN	CHECKED	APPROVED

Springwell Solar Farm



DOCUMENT:
APPLICATION DRAWINGS FOR
APPROVAL REGULATION 5(2)(k)

DRAWING TITLE:
STREETS, RIGHTS OF WAY AND
ACCESS PLANS
SHEET 10 OF 15

PIN REFERENCE NO:
EN010149/APP2.4

REVISION:
03

DATE:
JUN 2025

DRAWN:
RSK

SCALE:
1:2,500 at A1

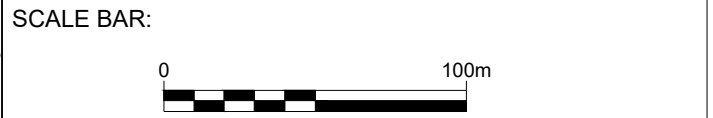

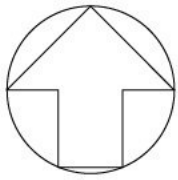
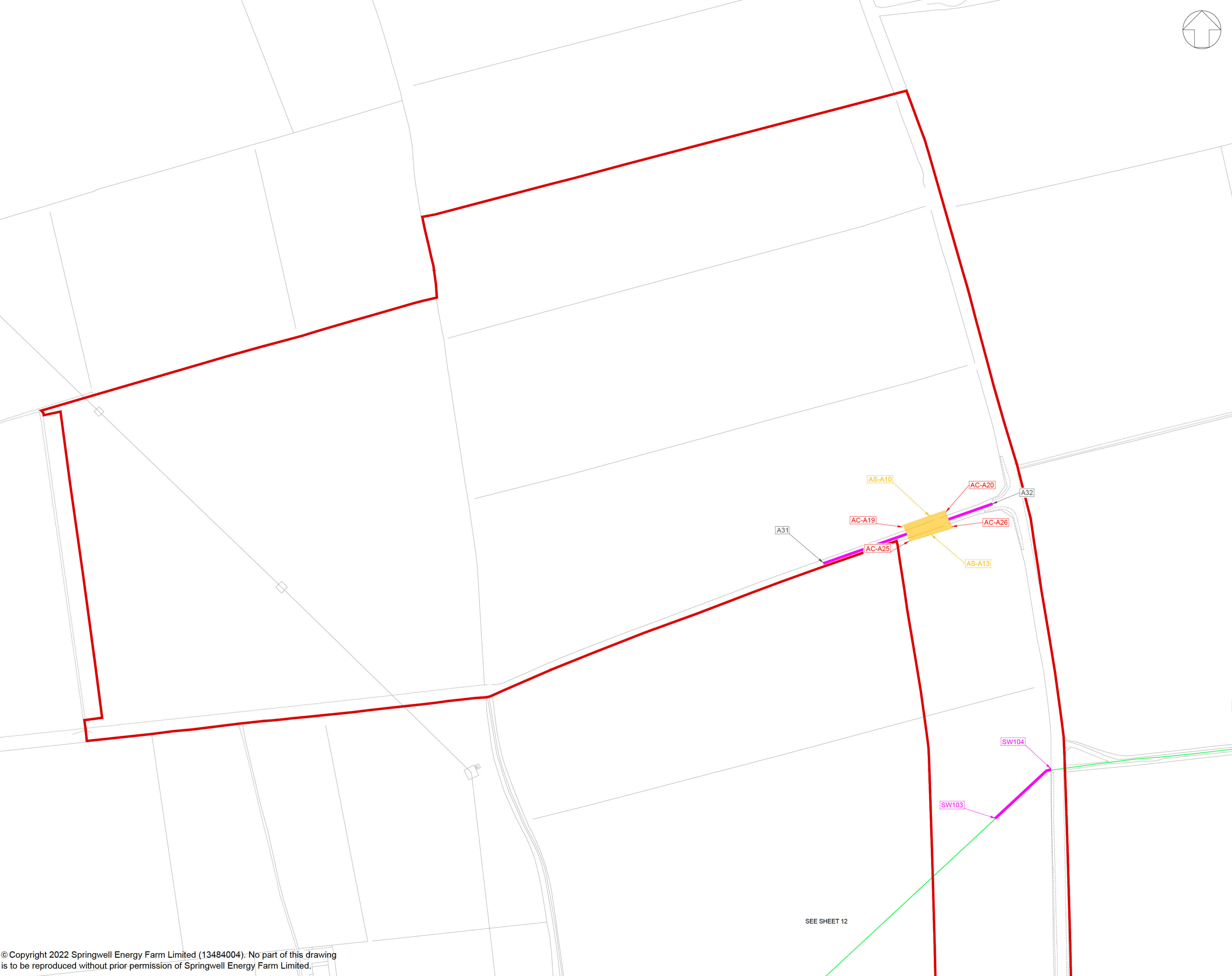

- KEY:**
- Order Limits
 - Areas outside of order limits
 - Existing Public Rights of Way (PROW)
 - Existing Permissive Path (EP)
 - Proposed Permissive Path (PP)
 - Proposed Enhanced Public Right of Way (PE)
 - Proposed Public Right of Way (FP)
 - Formation of a new access/passing bay (Location reference)
 - Extents of a new access/passing bay (Location reference)
 - Proposed Enhanced Public Right of Way (Location reference)
 - Proposed Public Right of Way (Location reference)
 - Proposed Permissive Path (Location reference)
 - Proposed Alteration to Streets (Location reference)
 - Formation of a new access/passing bay
 - Street Works (SW)
 - Street Works (location reference)
 - Potential Claimed Public Right of Way
 - Potential Claimed Public Right of Way (location reference)

- NOTES:**
- 1) ALL DIMENSIONS ARE IN METRES UNLESS STATED OTHERWISE.
 - 2) THE STREETS, RIGHTS OF WAY AND ACCESS PLANS SHOULD BE READ IN CONJUNCTION WITH THE DEVELOPMENT CONSENT ORDER (DCO) AND THE DOCUMENTS TO BE CERTIFIED UNDER IT, IN PARTICULAR PART 3 OF THE DCO AND SCHEDULES 4 - 7.
 - 3) FOR INFORMATION RELATING TO THE PROPOSED TEMPORARY TRAFFIC MANAGEMENT AND TRAFFIC REGULATION ORDERS PLEASE SEE TRAFFIC REGULATIONS PLAN.
 - 4) THE ORDER LIMITS HAS BEEN DRAWN TO THE LAND REGISTRY BOUNDARIES AND TOPOGRAPHICAL SURVEY DATA OF THE SITE. THE ACCURACY OF LAND REGISTRY AND THE TOPOGRAPHICAL SURVEY DIFFERS FROM THE OS BASE MAPPING WHICH RESULTS IN THE ORDER LIMITS NOT ALIGNING WITH THE LINE WORK SHOWN ON THE OS MAPPING.

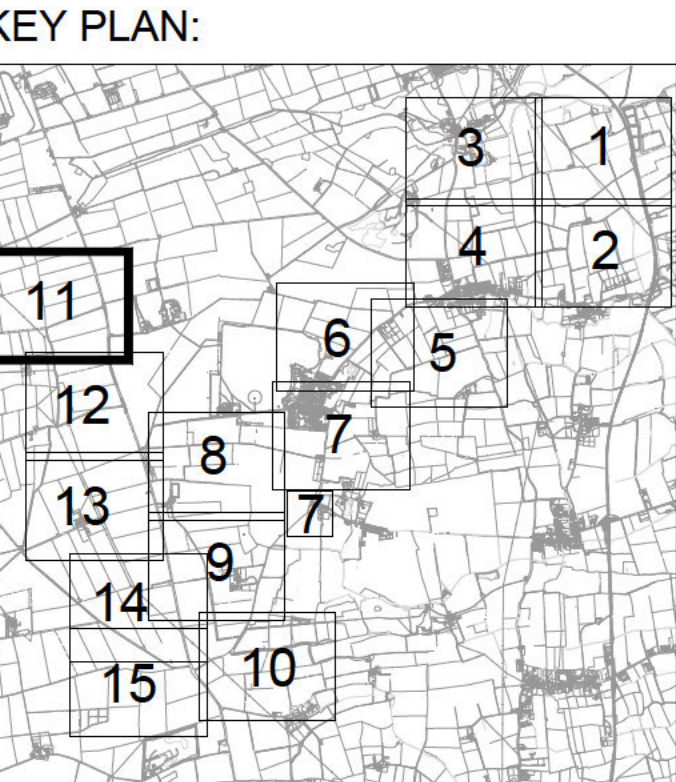

02	JAN 25	MINOR AMENDMENTS IN LINE WITH PINS GUIDANCE	RSK	RSK	EDF
01	NOV 24	DCO SUBMISSION	RSK	RSK	EDF
REVISION	DATE	DESCRIPTION	DRAWN	CHECKED	APPROVED

Springwell Solar Farm



DOCUMENT:
APPLICATION DRAWINGS FOR
APPROVAL REGULATION 5(2)(k)

DRAWING TITLE:
STREETS, RIGHTS OF WAY AND
ACCESS PLANS
SHEET 11 OF 15

PIN REFERENCE NO:
EN010149/APP12.4

REVISION:
02

DATE:
JAN 2025

DRAWN:
RSK

SCALE:
1:2,500 at A1



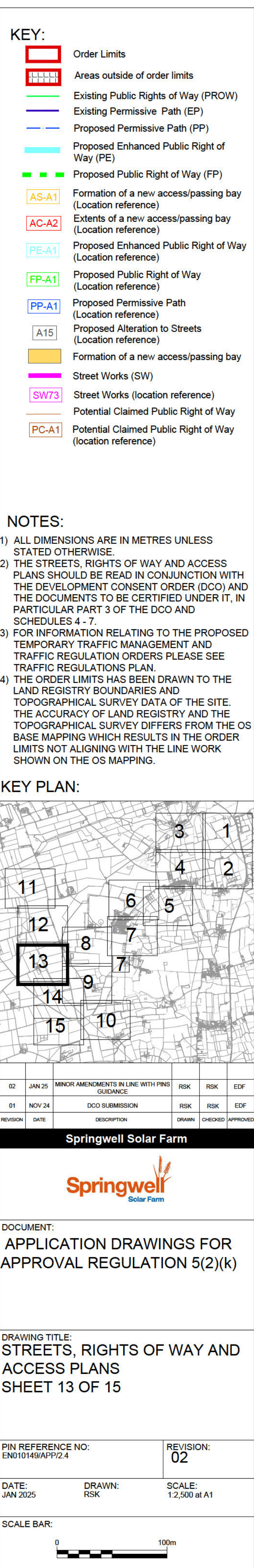

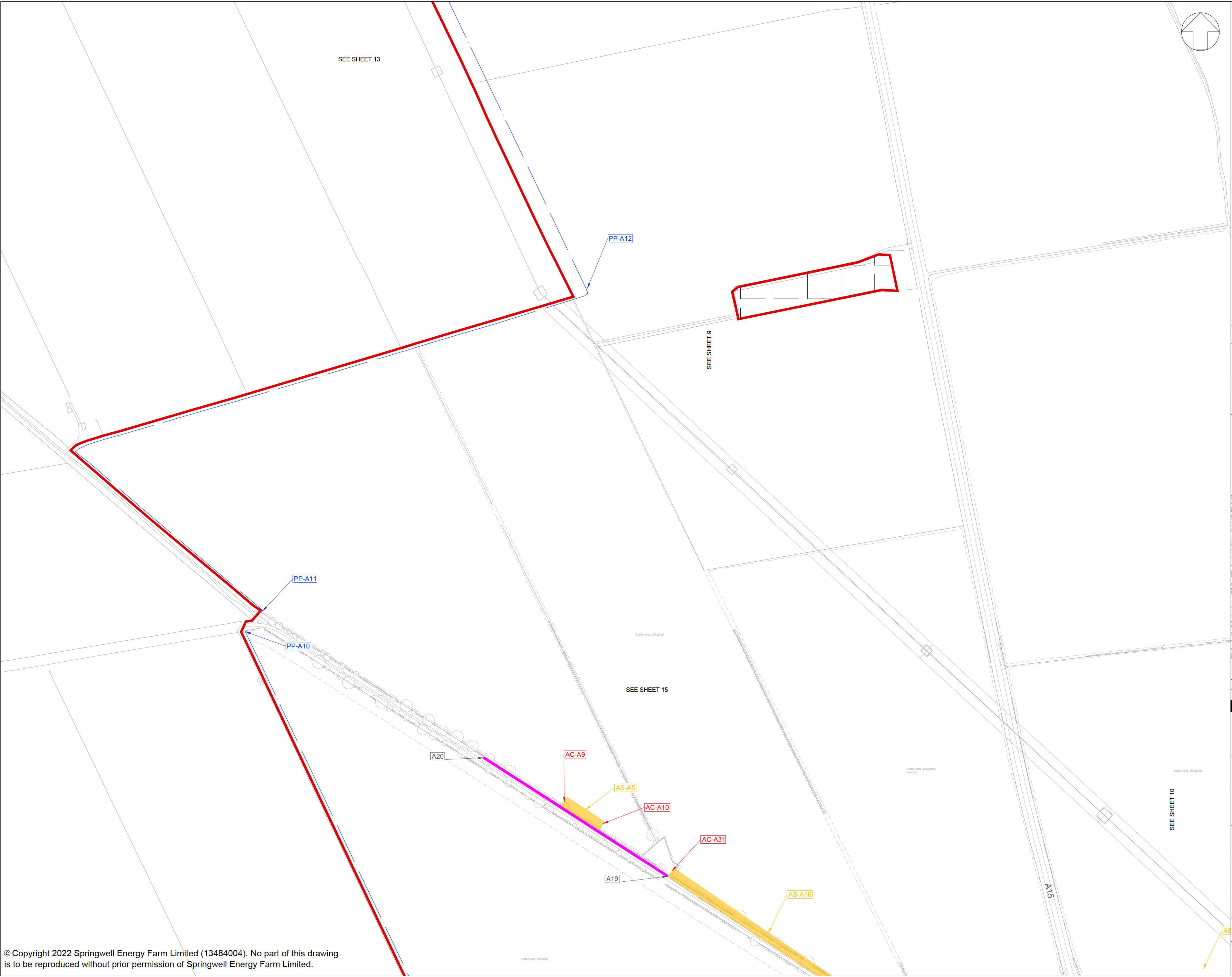

KEY:

- Order Limits
- Areas outside of order limits
- Existing Public Rights of Way (PROW)
- Existing Permissive Path (EP)
- Proposed Permissive Path (PP)
- Proposed Enhanced Public Right of Way (PE)
- Proposed Public Right of Way (FP)
- Formation of a new access/passing bay (Location reference)
- Extents of a new access/passing bay (Location reference)
- Proposed Enhanced Public Right of Way (Location reference)
- Proposed Public Right of Way (Location reference)
- Proposed Permissive Path (Location reference)
- Proposed Alteration to Streets (Location reference)
- Formation of a new access/passing bay
- Street Works (SW)
- Street Works (location reference)
- Potential Claimed Public Right of Way
- Potential Claimed Public Right of Way (location reference)

NOTES:

- ALL DIMENSIONS ARE IN METRES UNLESS STATED OTHERWISE.
- THE STREETS, RIGHTS OF WAY AND ACCESS PLANS SHOULD BE READ IN CONJUNCTION WITH THE DEVELOPMENT CONSENT ORDER (DCO) AND THE DOCUMENTS TO BE CERTIFIED UNDER IT, IN PARTICULAR PART 3 OF THE DCO AND SCHEDULES 4 - 7.
- FOR INFORMATION RELATING TO THE PROPOSED TEMPORARY TRAFFIC MANAGEMENT AND TRAFFIC REGULATION ORDERS PLEASE SEE TRAFFIC REGULATIONS PLAN.
- THE ORDER LIMITS HAS BEEN DRAWN TO THE LAND REGISTRY BOUNDARIES AND TOPOGRAPHICAL SURVEY DATA OF THE SITE. THE ACCURACY OF LAND REGISTRY AND THE TOPOGRAPHICAL SURVEY DIFFERS FROM THE OS BASE MAPPING WHICH RESULTS IN THE ORDER LIMITS NOT ALIGNING WITH THE LINE WORK SHOWN ON THE OS MAPPING.

KEY PLAN:

02	JAN 25	MINOR AMENDMENTS IN LINE WITH PINS GUIDANCE	RSK	RSK	EDF
01	NOV 24	DCO SUBMISSION	RSK	RSK	EDF
REVISION	DATE	DESCRIPTION	DRAWN	CHECKED	APPROVED

Springwell Solar Farm

DOCUMENT:
APPLICATION DRAWINGS FOR APPROVAL REGULATION 5(2)(k)

DRAWING TITLE:
**STREETS, RIGHTS OF WAY AND ACCESS PLANS
SHEET 14 OF 15**

PIN REFERENCE NO: END10149/APP12.4		REVISION: 02
DATE: JAN 2025	DRAWN: RSK	SCALE: 1:2,500 at A1

SCALE BAR:

© Copyright 2022 Springwell Energy Farm Limited (13484004). No part of this drawing is to be reproduced without prior permission of Springwell Energy Farm Limited.

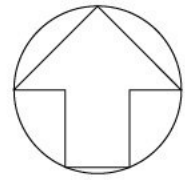
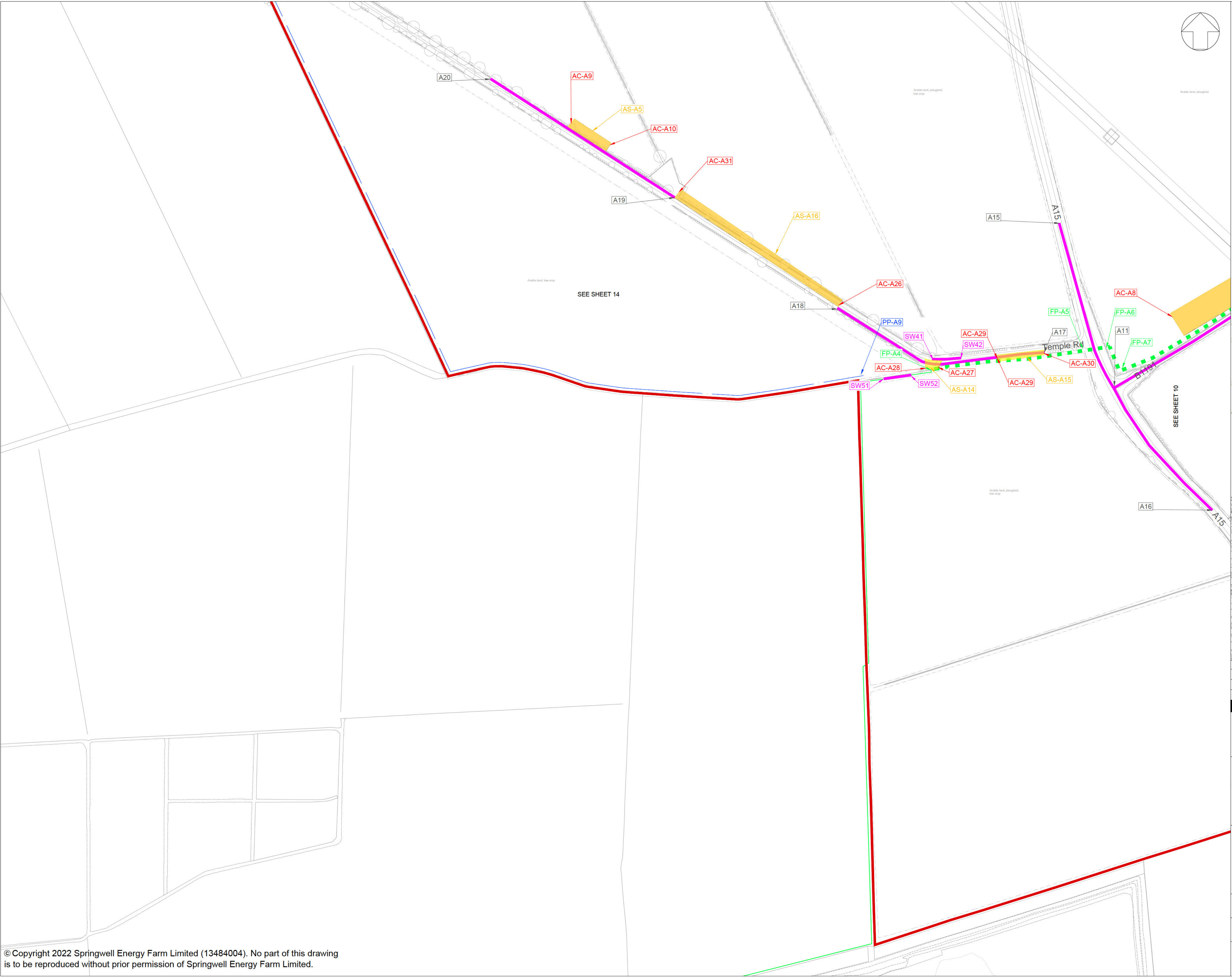

- KEY:**
- Order Limits
 - Areas outside of order limits
 - Existing Public Rights of Way (PROW)
 - Existing Permissive Path (EP)
 - Proposed Permissive Path (PP)
 - Proposed Enhanced Public Right of Way (PE)
 - Proposed Public Right of Way (FP)
 - Formation of a new access/passing bay (Location reference)
 - Extents of a new access/passing bay (Location reference)
 - Proposed Enhanced Public Right of Way (Location reference)
 - Proposed Public Right of Way (Location reference)
 - Proposed Permissive Path (Location reference)
 - Proposed Alteration to Streets (Location reference)
 - Formation of a new access/passing bay
 - Street Works (SW)
 - Street Works (location reference)
 - Potential Claimed Public Right of Way
 - Potential Claimed Public Right of Way (location reference)

- NOTES:**
- 1) ALL DIMENSIONS ARE IN METRES UNLESS STATED OTHERWISE.
 - 2) THE STREETS, RIGHTS OF WAY AND ACCESS PLANS SHOULD BE READ IN CONJUNCTION WITH THE DEVELOPMENT CONSENT ORDER (DCO) AND THE DOCUMENTS TO BE CERTIFIED UNDER IT, IN PARTICULAR PART 3 OF THE DCO AND SCHEDULES 4 - 7.
 - 3) FOR INFORMATION RELATING TO THE PROPOSED TEMPORARY TRAFFIC MANAGEMENT AND TRAFFIC REGULATION ORDERS PLEASE SEE TRAFFIC REGULATIONS PLAN.
 - 4) THE ORDER LIMITS HAS BEEN DRAWN TO THE LAND REGISTRY BOUNDARIES AND TOPOGRAPHICAL SURVEY DATA OF THE SITE. THE ACCURACY OF LAND REGISTRY AND THE TOPOGRAPHICAL SURVEY DIFFERS FROM THE OS BASE MAPPING WHICH RESULTS IN THE ORDER LIMITS NOT ALIGNING WITH THE LINE WORK SHOWN ON THE OS MAPPING.

KEY PLAN:

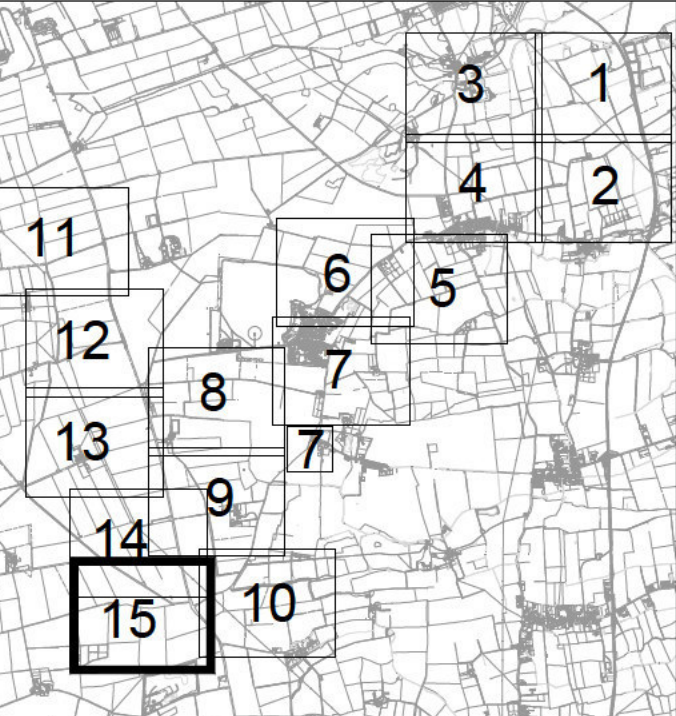

02	JAN 25	M NOR AMENDMENTS IN L LINE WITH P NS GUIDANCE	RSK	RSK	EDF
01	NOV 24	DCO SUBMISSION	RSK	RSK	EDF
REVISION	DATE	DESCRIPTION	DRAWN	CHECKED	APPROVED

Springwell Solar Farm



DOCUMENT:
APPLICATION DRAWINGS FOR
APPROVAL REGULATION 5(2)(k)

DRAWING TITLE:
STREETS, RIGHTS OF WAY AND
ACCESS PLANS
SHEET 15 OF 15

PIN REFERENCE NO:
END10149/AP72.4

REVISION:
02

DATE:
JAN 2025

DRAWN:
RSK

SCALE:
1:2,500 at A1



